

# EFC MODULE I SUB-ASSEMBLY

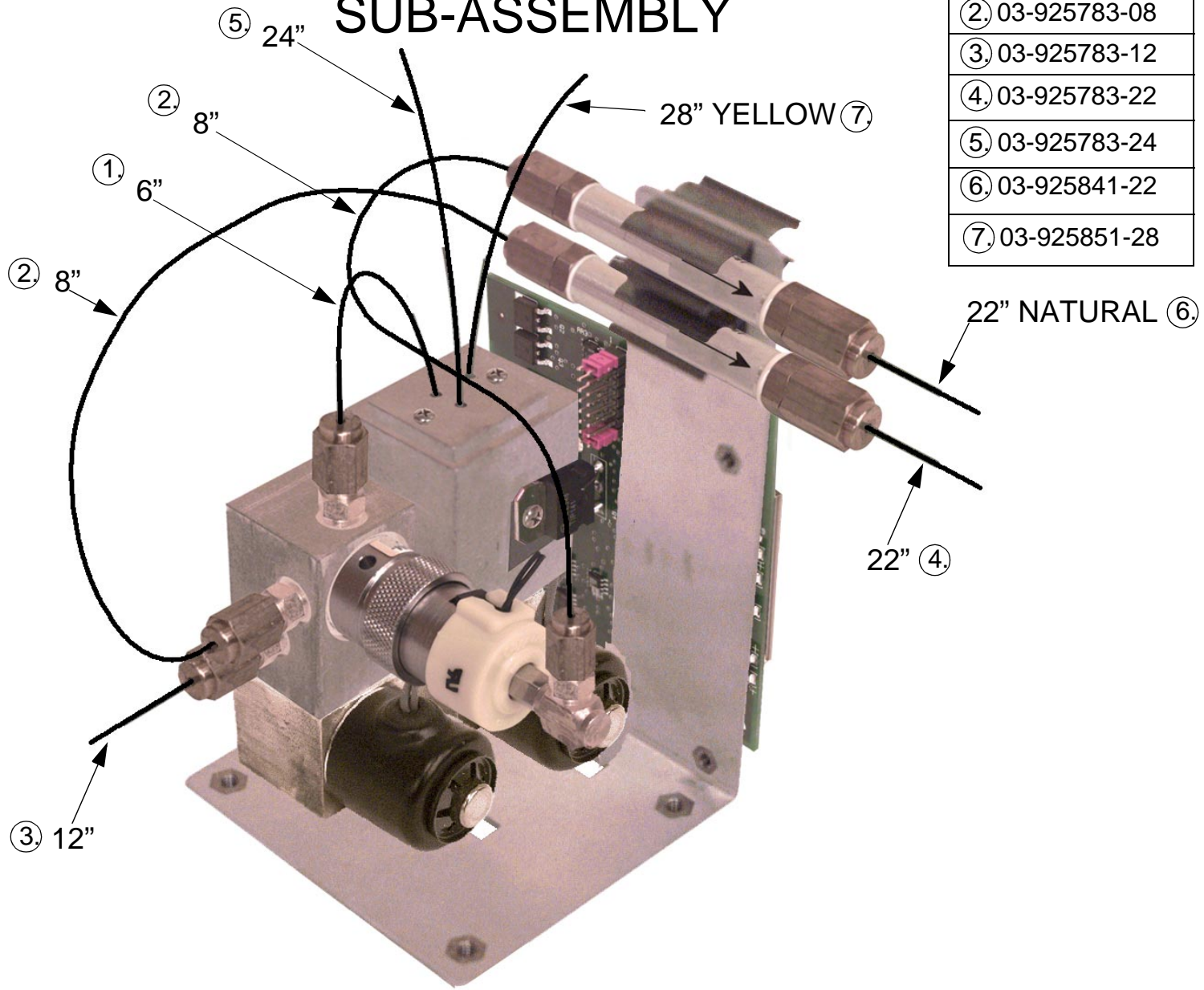

Peek Tubing	
①	03-925783-06
②	03-925783-08
③	03-925783-12
④	03-925783-22
⑤	03-925783-24
⑥	03-925841-22
⑦	03-925851-28

**MANIFOLD ASSY.**  
GOTO PAGE 3

**MANIFOLD ASSY.**  
GOTO PAGE 4

**FILTER ASSY.**  
SEE FILTER SUB-ASSEMBLY

**NOTES: (UNLESS OTHERWISE SPECIFIED)**  
1. SEE O-RING PRE-ASSEMBLY INSPECTION PROCEDURE.

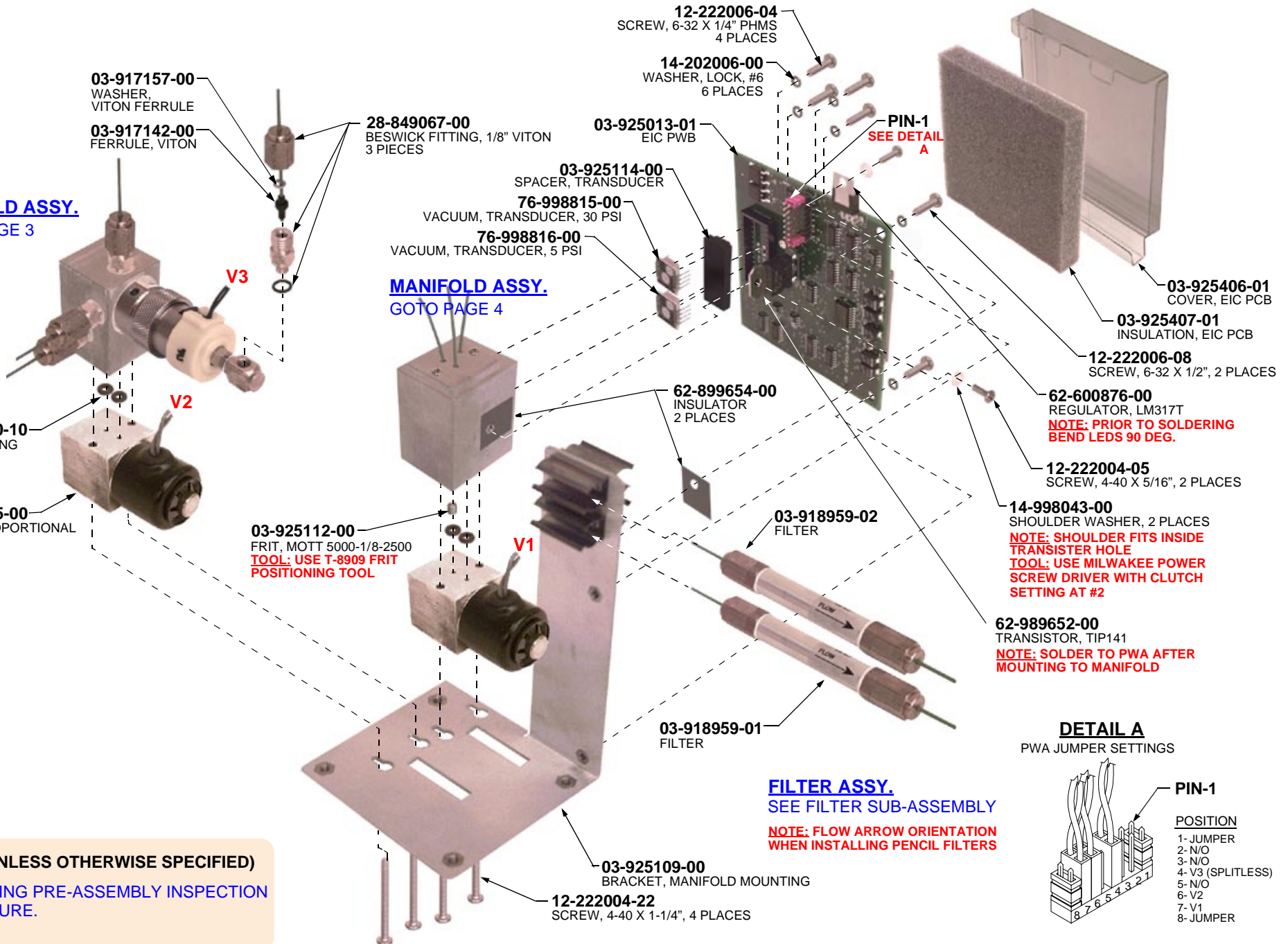

**DETAIL A**  
PWA JUMPER SETTINGS

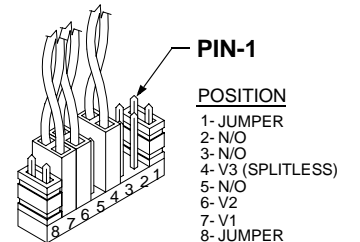



**MANIFOLD ASSY.**  
GOTO PAGE 2 FOR  
INSTALLATION

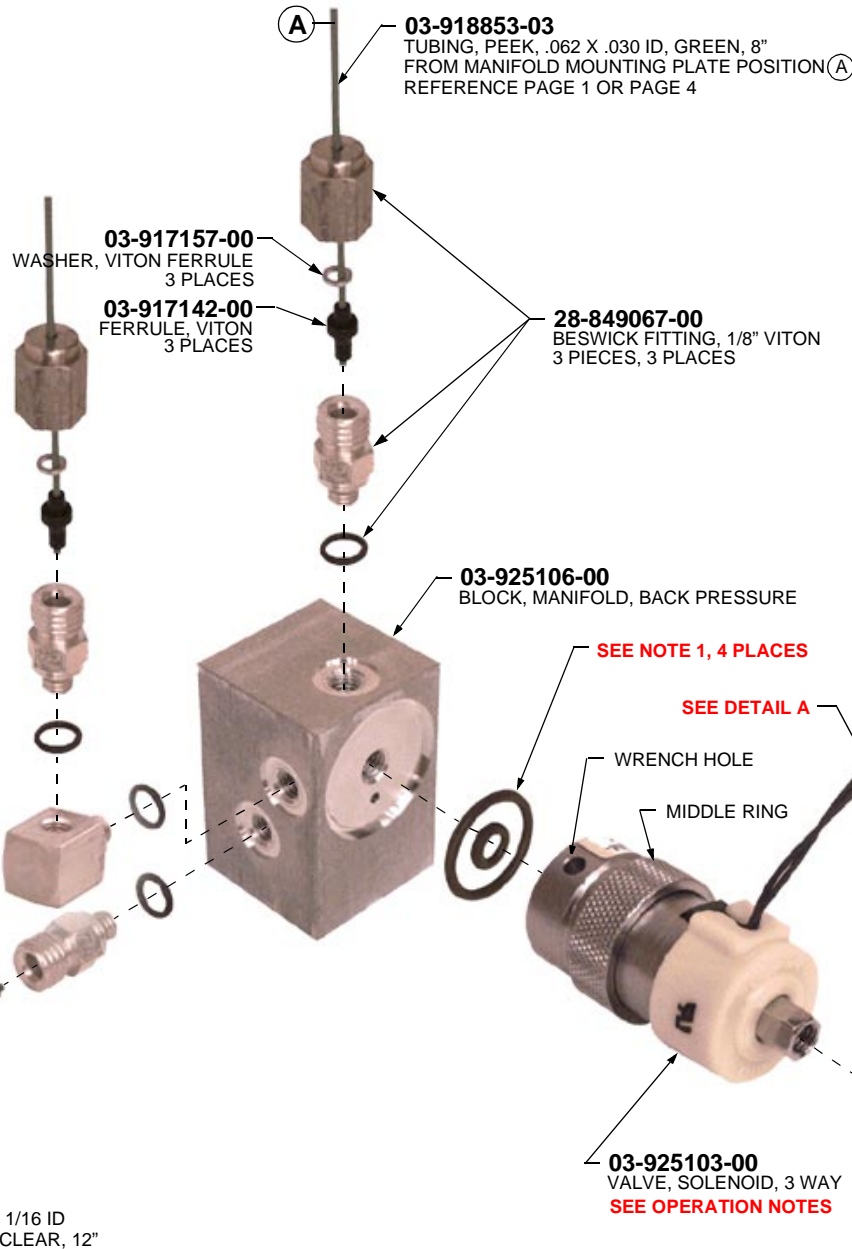

**DETAIL A**  
WIRE TERMINATION

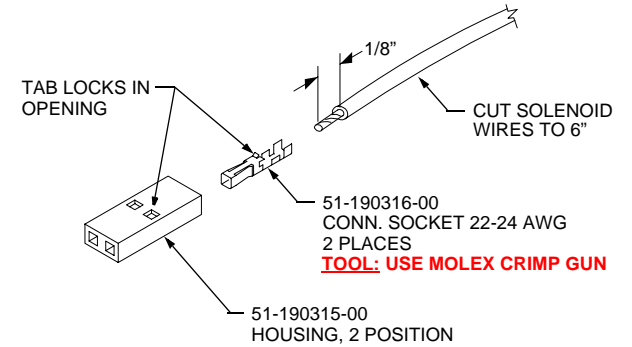

**NOTES: (UNLESS OTHERWISE SPECIFIED)**

1. SEE O-RING PRE-ASSEMBLY INSPECTION PROCEDURE.

**OPERATION NOTES, SOLENOID VALVE ASSY.**

2. THE SOLENOID VALVE MIDDLE RING MUST BE LOOSE BEFORE ASSEMBLY.
3. AFTER CLEANING O-RINGS, MANIFOLD AND SOLENOID VALVE MATING SURFACES, HAND TIGHTEN SOLENOID VALVE TO MANIFOLD BLOCK.
4. INSERT SPECIAL TOOL IN WRENCH HOLE AND HAND TIGHTEN FURTHER.
5. POSITION VALVE OUTLET (ELBOW FITTING) IN VERTICAL POSITION AND TIGHTEN MIDDLE RING HAND TIGHT.



**MANIFOLD ASSY.**  
GOTO PAGE 2 FOR  
INSTALLATION

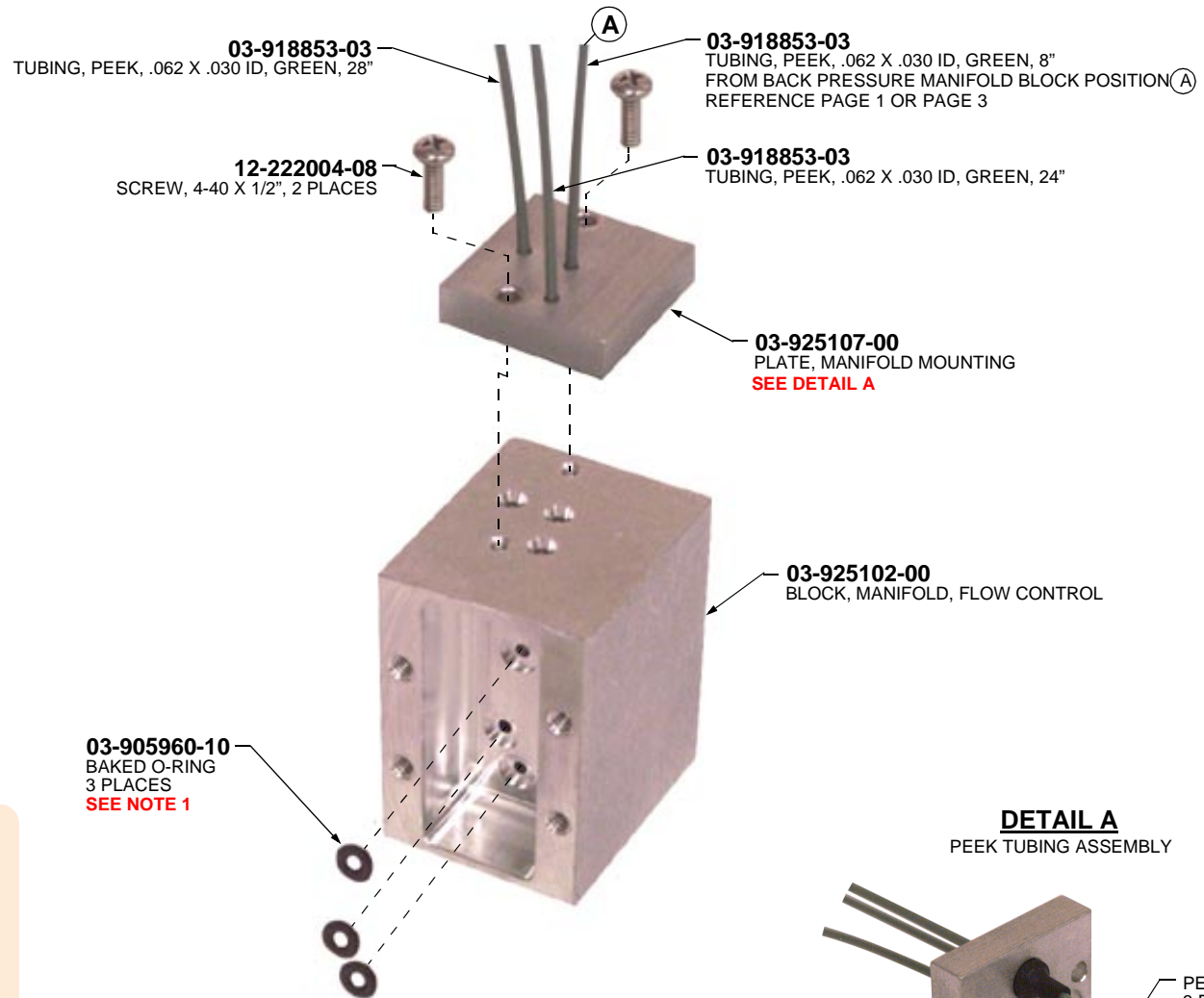

**DETAIL A**  
PEEK TUBING ASSEMBLY

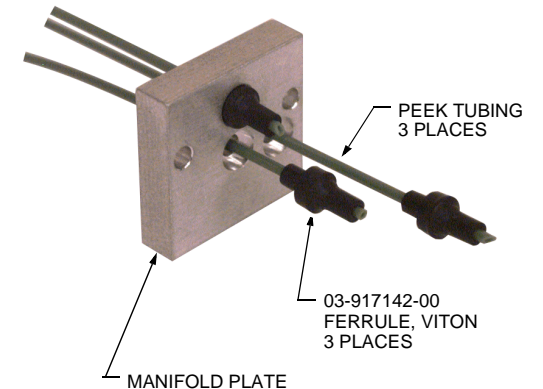

**NOTES: (UNLESS OTHERWISE SPECIFIED)**

1. SEE O-RING PRE-ASSEMBLY INSPECTION PROCEDURE.

**OPERATION NOTES**

2. AFTER CLEANING O-RINGS AND MANIFOLD MATING SURFACE, SET O-RINGS IN PLACE WITH TWEEZERS (DO NOT TOUCH O-RINGS).

3. FIRMLY SEAT O-RINGS IN THE MANIFOLD BLOCK.

4. INSPECT SEATING OF O-RINGS, IF NECESSARY PRESS TO SEAT USING TWEEZERS.

5. AFTER O-RING PLACEMENT "DUST-OFF" AGAIN.